

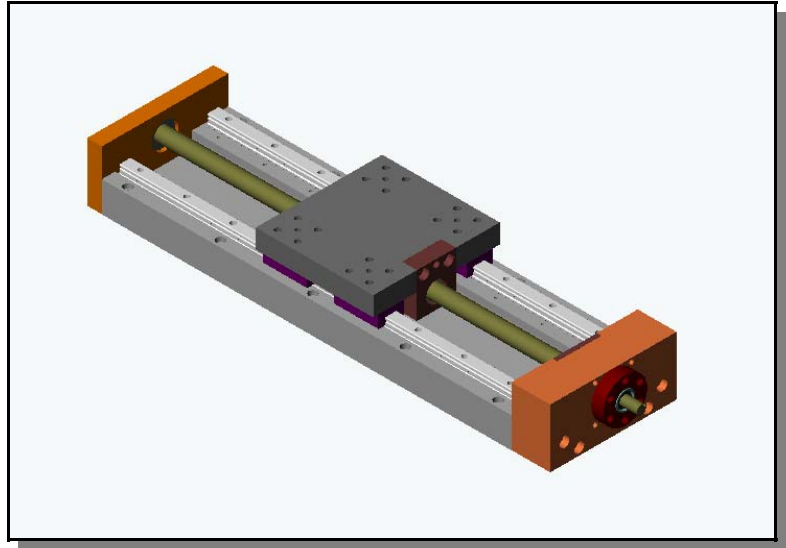

135 West Fay Ave.
 Addison, Illinois 60101
 (630) 458-0070
 www.cmmautomation.com

Designed for power driven applications, these slides come equipped with a 3/4 x .2 lead rolled ballscrew, with a preloaded nut. Screws are supported by an angular contact ball bearing thrust assembly at the drive end, and a sealed ball bearing at the free end. The housing for the thrust assembly can also be fitted with an optional motor adaptor housing and coupling (motor information required). Consult factory for application requirements such as loads, speeds and covers.



Linear Way and Roller Bearing Slide Tolerances

Over All Height: +/- .004 in.
 Vertical Tracking: .001 in./Ft.
 Horizontal Tracking: .001 in./Ft.
 Parallelism: Saddle to Base .002 in.

MODEL #	WIDTH	STROKE	OAL	WEIGHT/lbs.
LB-BSS 6.5 X 2" STK	6.5	2 in.	13.26	23
LB-BSS 6.5 X 5" STK	6.5	5 in.	15.62	24.5
LB-BSS 6.5 X 7" STK	6.5	7 in.	17.98	26
LB-BSS 6.5 X 9" STK	6.5	9 in.	20.34	28.5
LB-BSS 6.5 X 12" STK	6.5	12 in.	22.71	30
LB-BSS 6.5 X 14" STK	6.5	14 in.	25.07	31.5
LB-BSS 6.5 X 16" STK	6.5	16 in.	27.43	33
LB-BSS 6.5 X 19" STK	6.5	19 in.	29.79	34.5
LB-BSS 6.5 X 21" STK	6.5	21 in.	32.15	36
LB-BSS 6.5 X 23" STK	6.5	23 in.	34.52	37.5